



505  
UNION  
STATION



Seattle  
Great Wheel

SEATTLE  
CBD

FIRST  
HILL

Alaskan Wy

Western Ave

1st Ave

2nd Ave

3rd Ave

4th Ave

5th Ave

Boren Ave

WA State  
Ferries

Yesler Wy

I-5

YESLER

PIONEER  
SQUARE

S Washington St

S Main St

S Jackson St

505  
Union  
Station

CHINATOWN  
INTERNATIONAL  
DISTRICT

5th Ave S

Lumen  
Field

Seattle Blvd S

SR-99

4th Ave S

I-90

T-Mobile  
Park

SODO

Iconic Design, Unparalleled Access



# Retail Space

AVAILABLE NOW

Floor	Suite	Use	Size	Divisible/Combinable	Virtual Tour (click button to access)	Available
1	110	Retail	3,226 RSF	n/a	<a href="#">Virtual Tour</a>	Now
1	120	Retail	2,368 RSF	n/a	n/a	Now



**Located in Chinatown-International District, immediately south of the financial core, 505 Union Station is a busy hub for commuters and stadium goers.**

- Situated by Lumen Field, T-Mobile Park, and Chinatown-International District & Pioneer Square restaurants and amenities
- Adjacent to Light Rail tunnel, Sounder commuter train, and numerous bus routes
- Easy access to/from I-5, I-90, and SR-99
- Walk Score: 99 & Transit Score: 100

# Floor 1

## FLOOR PLAN

LIGHT RAIL STATION

5th Ave S

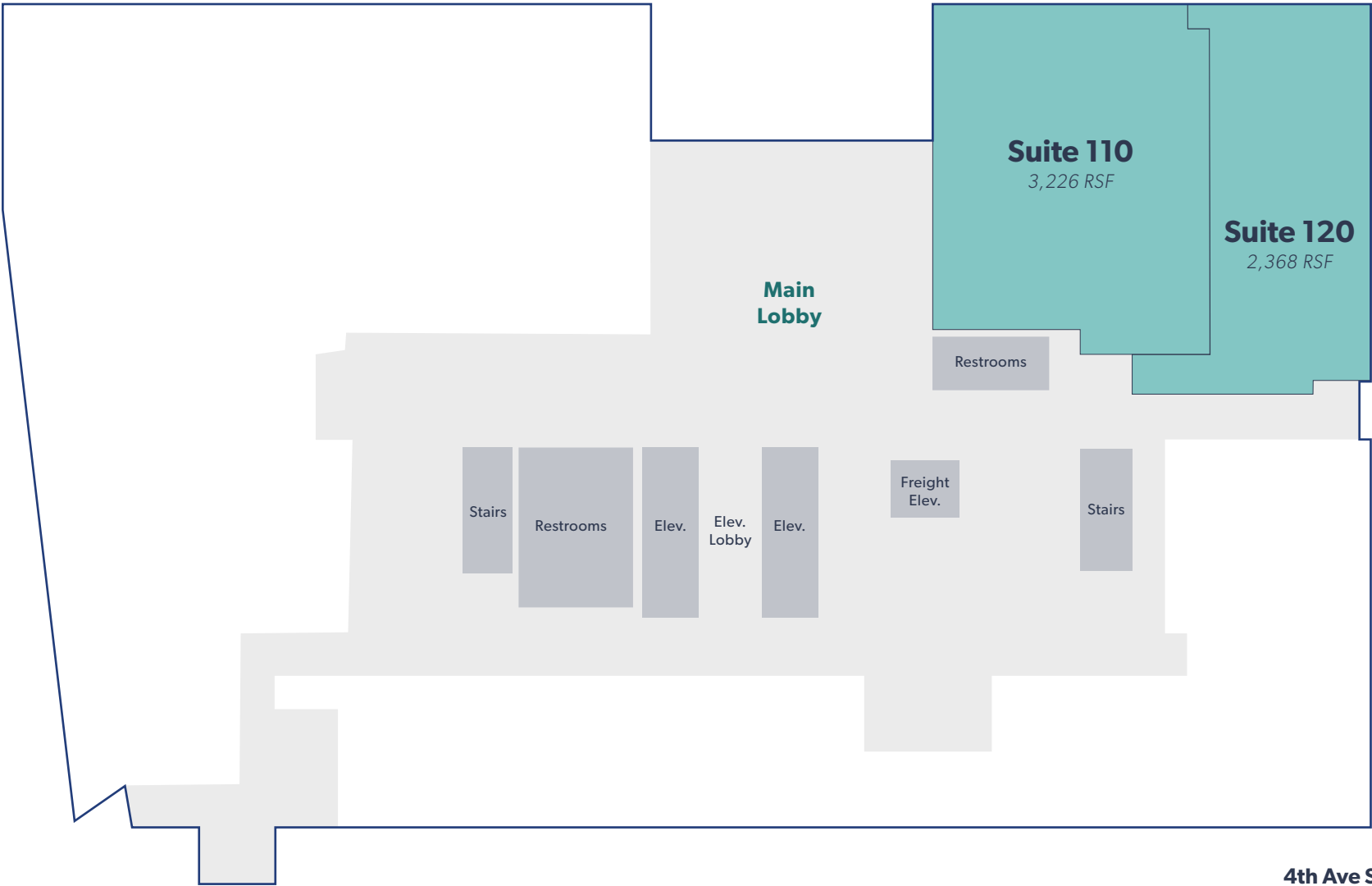

WALKWAY TO TRAIN & STADIUMS ↓

4th Ave S

◀ NORTH





Situated adjacent to the light rail tunnel, King Street Station, and numerous bus lines & freeways, 505 Union Station is a hub for commuters





## Contact

**Robert S. Arron**

[roba@vulcan.com](mailto:roba@vulcan.com)

206.342.2025

**Geralyn D. Vannoy**

[geralynv@vulcan.com](mailto:geralynv@vulcan.com)

206.342.2025